

Montage

Installation Manual

GLASGOW

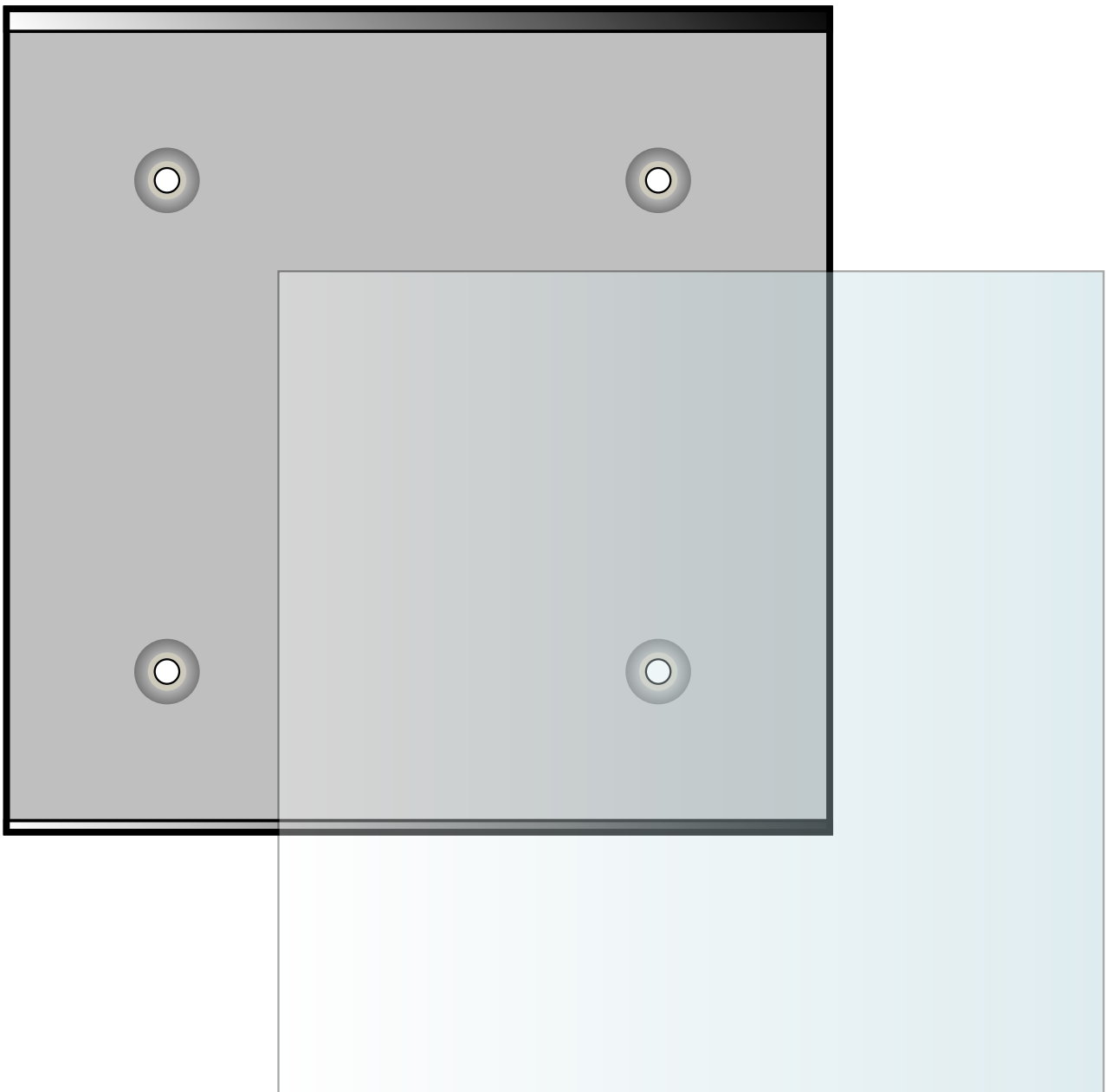

1.

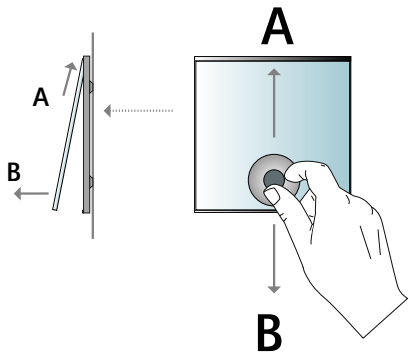

2.

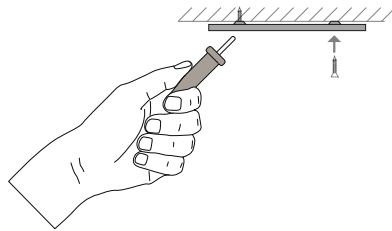

3.

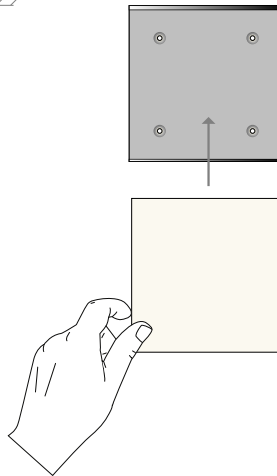

4.

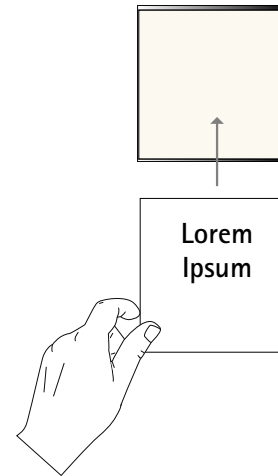

5.

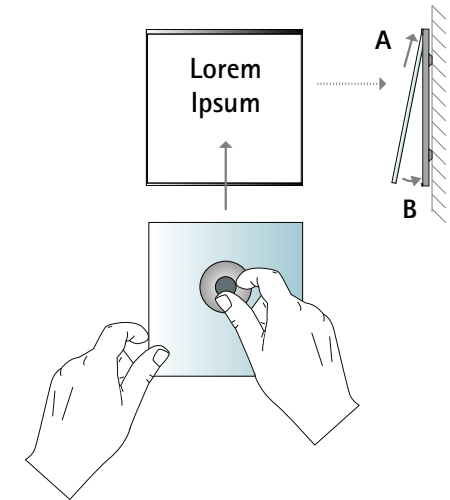

- A: Scheibe mit Sauger anheben und gegen das obere Profil drücken
- B: Scheibe entnehmen
- A: *lift glass panel by using vacuum cup*
- B: *remove glass*

- A: Scheibe mit Sauger in die obere Schiene einsetzen
- B: Scheibe absenken und in die untere Schiene gleiten lassen
- A: *put in glass panel in top groove by using vacuum cup*
- B: *put down glass panel in bottom groove*

Verpackungsinhalt:

- 1x Grundwanne
- 1x Karton
- 1x Glasscheibe

Delivery:

- 1x backtray
- 1x cardboard
- 1x safety glass panel

